



SOCIAL EVENT PACKAGE

Grove at Briar Barn Inn can host social dinners in both private, and semi-private areas of the restaurant for up to 100 guests between the hours of 5pm and 9pm. Pricing below is for a three hour event; one additional hour may be requested dependent on our event schedule.

GROVE - MAIN DINING AREA

PRIVATE 3-HOUR EVENT FOR 50-100 GUESTS

Sunday - Thursday Evening

FOOD AND BEVERAGE MINIMUM \$4,000
ROOM FEE \$1,000

Friday Evening

FOOD AND BEVERAGE MINIMUM \$5,000
ROOM FEE \$1,000

THE BURROW

PRIVATE 3-HOUR EVENT FOR UP TO 24 GUESTS*

Sunday - Thursday Evening

FOOD AND BEVERAGE MINIMUM \$1,800
ROOM FEE \$500

Friday Evening

FOOD AND BEVERAGE MINIMUM \$2,000
ROOM FEE \$500

**Patio Rental option available for \$2,000, weather dependent*

**Patio Rental option available for \$2,400, weather dependent*

THE BRAMBLE HOUSE

SEMI-PRIVATE 3-HOUR EVENT FOR UP TO 32 GUESTS

Sunday - Thursday Evening

FOOD AND BEVERAGE MINIMUM \$1,800
ROOM FEE \$250

Friday Evening

FOOD AND BEVERAGE MINIMUM \$2,000
ROOM FEE \$250

All food and beverage rates are subject to a 20% administrative fee, and all pricing is subject to the MA state and local tax at the time of your event

PROPERTY LAYOUT

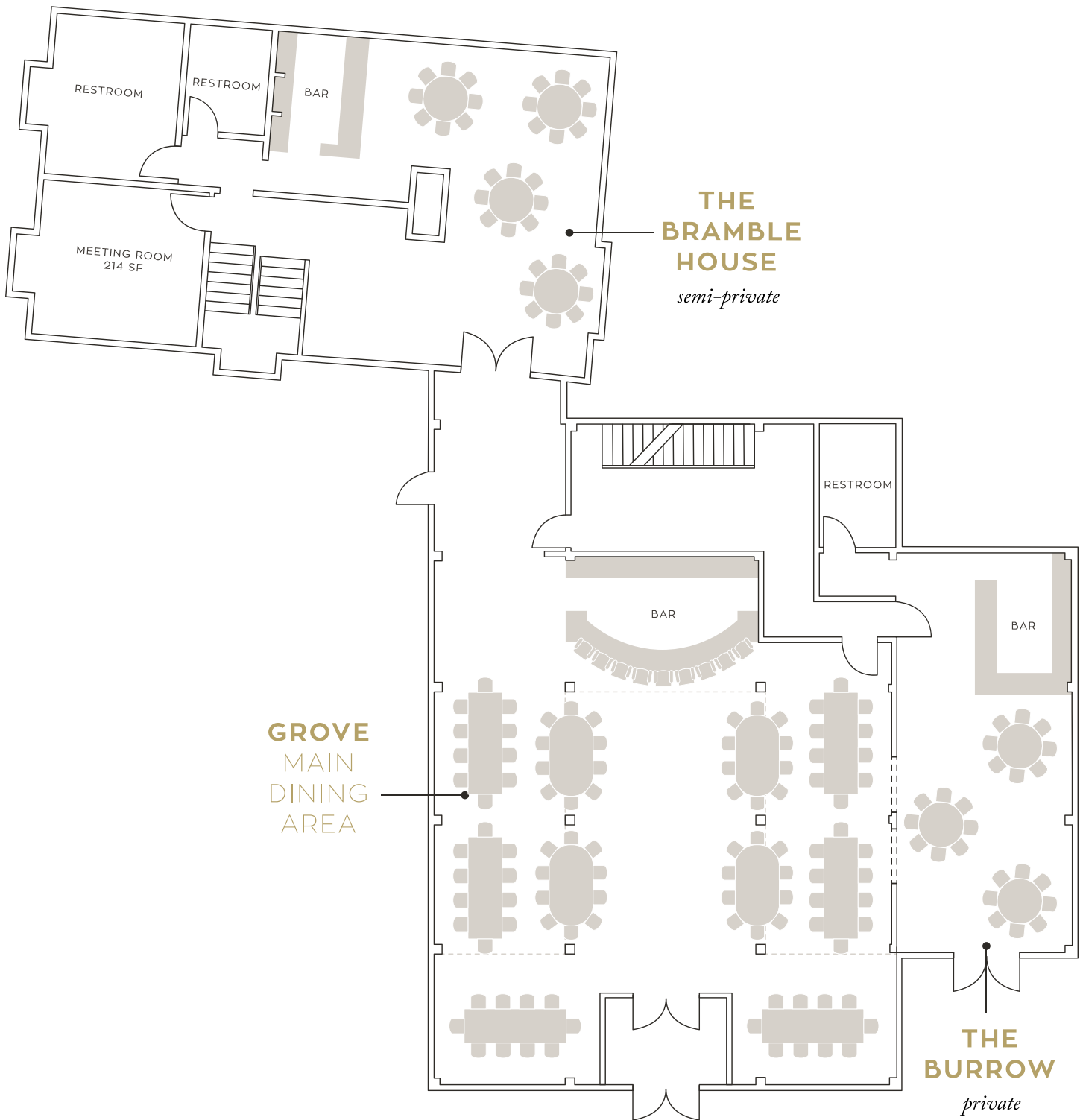

PLANNING YOUR EVENT

Grove at Briar Barn Inn will provide support from an Event Coordinator to design a layout and timeline for your event.

HOW MANY GUESTS CAN YOUR SPACES ACCOMMODATE?

Grove at Briar Barn Inn can host social dinners for groups of 15-32 guests. The Burrow hosts events for up to 24 and The Bramble House can hold up to 32 guests.

WHERE DO MY GUESTS PARK?

Self parking in our lot is available.

CAN WE PLAY MUSIC OR HIRE MUSICIANS?

Yes! Grove at Briar Barn Inn will provide background level music from a house playlist. Any live music (DJ included) must be approved by your event coordinator. We can also refer you to a list of preferred vendors for music if you are interested in hiring an event professional.

WHAT DO I NEED TO BRING FOR DECORATIONS?

Grove at Briar Barn Inn will provide setup and signs for all applicable food and beverage stations. You may want to plan for table centerpieces, a guest favor and seating cards for your guests if you plan to assign seating. You may also choose to add personal décor (as allowed).

ARE THERE ANY RULES OR RESTRICTIONS ABOUT DÉCOR?

We do not allow confetti or glitter on our property. We do not allow any new nails, hooks or adhesive strips to be placed on our walls. We do allow the use of real candles, but they must be in a vessel or votive. We also encourage you to have all décor pre-assembled prior to your arrival. If you have a specific décor request, please ask your coordinator.

CAN I BRING IN ADDITIONAL FOOD?

We do not allow any outside food or drink to be brought into the restaurant, with the exception of an approved cake or dessert from a licensed vendor.

DO YOU OFFER KIDS' MEALS?

We offer more kid-friendly meal options for our plated menus, at a rate of \$25 per child under the age of 12.

WHEN CAN I SETUP FOR THE DINNER?

Clients have access for setup 1 hour before the event and for 30 minutes after the event end time. Please note that Grove at Briar Barn Inn reserves the right to remain open for tours and meetings in other areas of the space before, during, and after your event.

DO MY GUESTS NEED TO MAKE THEIR MENU SELECTIONS IN ADVANCE?

Yes. Guests must make their entree selections prior to the event. You can include entree options with your invitation. Final numbers are due to your coordinator 14 days prior to the event.